



Active Head 3D

This is a remotely controlled panoramic gyro stabilized head designed to work with 3D Rig and heavy cameras up to 60 kg. On this head can be easily set up different types of 3D Rig such as companies as 3ality Digital, P + S Technik, etc. It's available with a variety of control options such as Handwheels, Pan Bar, or Joystick.

Features:

- Solid and reliable construction
- Good camera mount and accessories access
- Lens auto calibration
- Remotely controlled handling of lens Parameters
- Power supply extended-range

Technical Specifications

Height	1160 mm
Width	900 mm
Depth	650 mm max
Power supply AC	220V~ +/-15% *5A max
Power supply DC	19-72 VDC@ 1kW peak
Pan angular speed (max)	90 deg\sec
Tilt angular speed (max)	90 deg\sec
Roll angular speed (max)	90 deg\sec
Pan angular acceleration	800 deg\sec ²
Tilt angular acceleration	800 deg\sec ²
Roll angular acceleration	800 deg\sec ²
Weight	36 kg

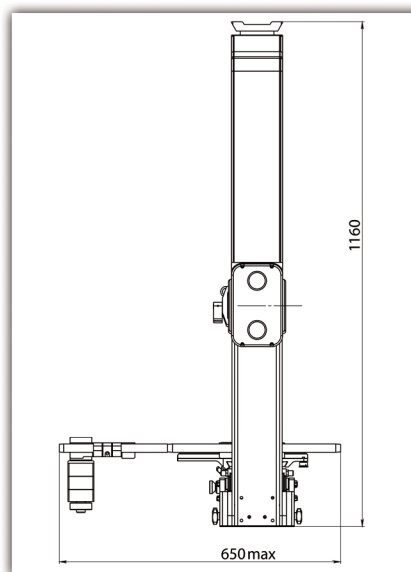
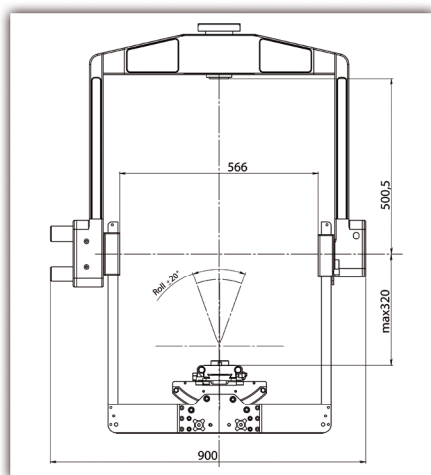
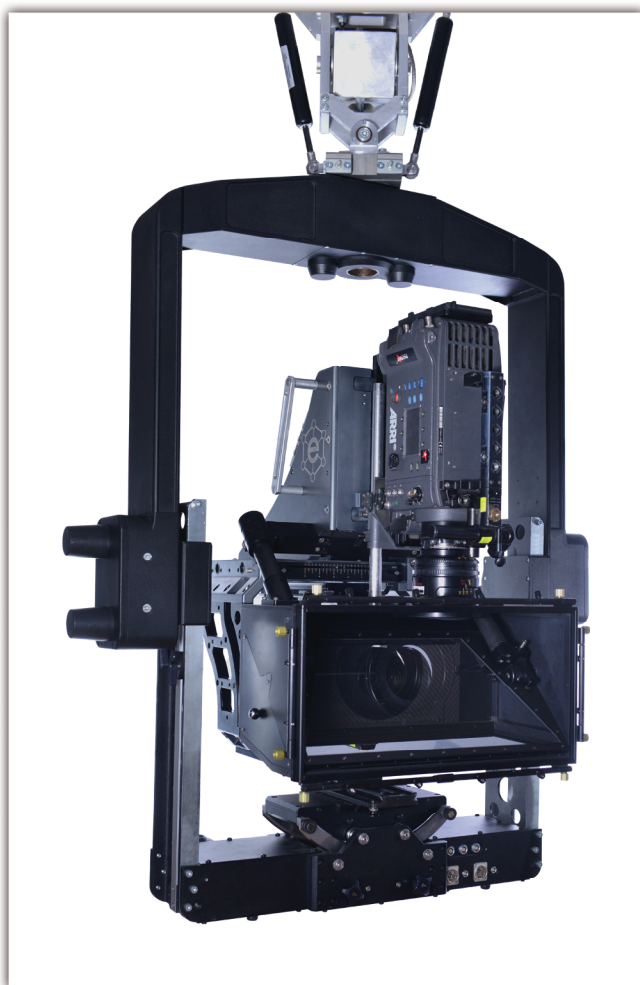

02660, Kiev, Ukraine
22, Zakrevskogo str.



Website: www.opertec.tv
E-mail: office@opertec.tv



Phone: +38 044 501 39 44
Fax: +38 044 501 39 44



OperTec